

- C7.....Algonquin Rd
- B8.....Apache
- E7.....Appleby Dr
- F5.....Arapahoe Ct
- B6.....Arikara
- E11.....Buckhaven Ln
- E10.....Button Rock RD
- B8.....Cherokee Rd
- E10.....Cheyenne Rd
- D4.....Chieftan Ct
- A10.....Chipmunk Dr
- A6.....Choctaw
- D4.....Cody Ct
- C6.....Comanche
- F2.....Cree Ct
- H3.....Crow Ln
- D11.....Deer Ln
- E11.....Deer Hollow Ct
- H6.....Eagle Dr
- H7.....Easton Rd
- A5-G12...E Highway 36
- D12.....Elk Rd
- D9, E6, H7...Estes Park Estates Dr
- D11.....Fawn Ct
- H3.....Hopi Ct
- E4.....Iroquois
- C7, F5, H1...Kiowa Rd
- F7.....Lookout Dr
- C7.....May Ave
- C10.....Meadow Rd
- B7.....Mohawk Rd
- C11.....Moose Rd
- F6.....Navajo Ct
- C8.....Nez Perce Ct
- G2.....Ogallala Ct
- E6.....Ottawa Ct
- F3.....Pima Rd
- C11...Pinewood Ct
- C10...Pinewood Dr
- D5.....Seminole Ct
- E5.....Seneca
- B9.....Sioux Rd
- D11...Tishmingo
- H3.....Ute Crossing
- D11...Wapiti Dr
- F3.....Wichita Rd

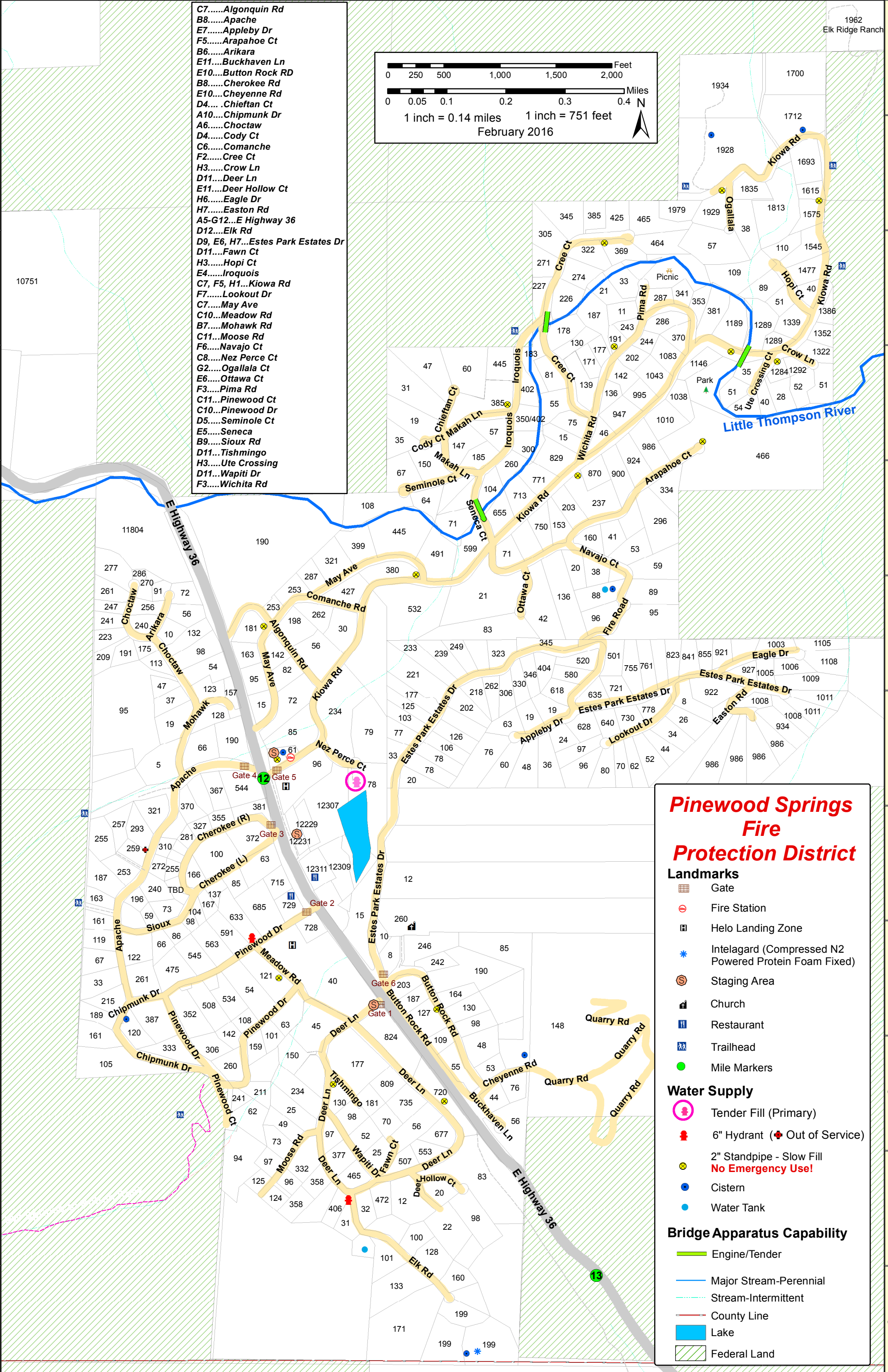
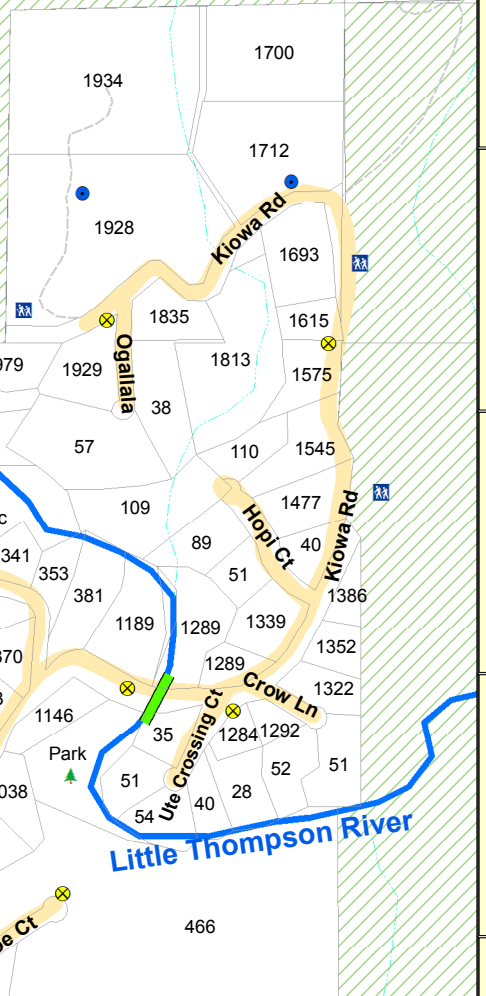
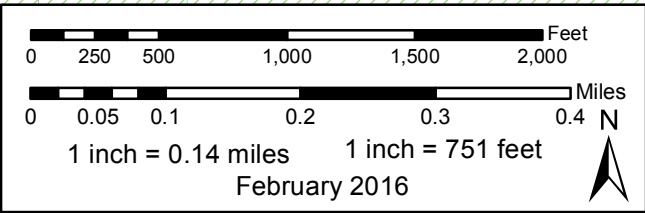

## Pinewood Springs Fire Protection District

- ### Landmarks
- Gate
  - Fire Station
  - Helo Landing Zone
  - Intelgard (Compressed N2 Powered Protein Foam Fixed)
  - Staging Area
  - Church
  - Restaurant
  - Trailhead
  - Mile Markers
- ### Water Supply
- Tender Fill (Primary)
  - 6" Hydrant ( Out of Service)
  - 2" Standpipe - Slow Fill
  - No Emergency Use!
  - Cistern
  - Water Tank
- ### Bridge Apparatus Capability
- Engine/Tender
  - Major Stream-Perennial
  - Stream-Intermittent
  - County Line
  - Lake
  - Federal Land